

BERRY COLLEGE

Main Campus

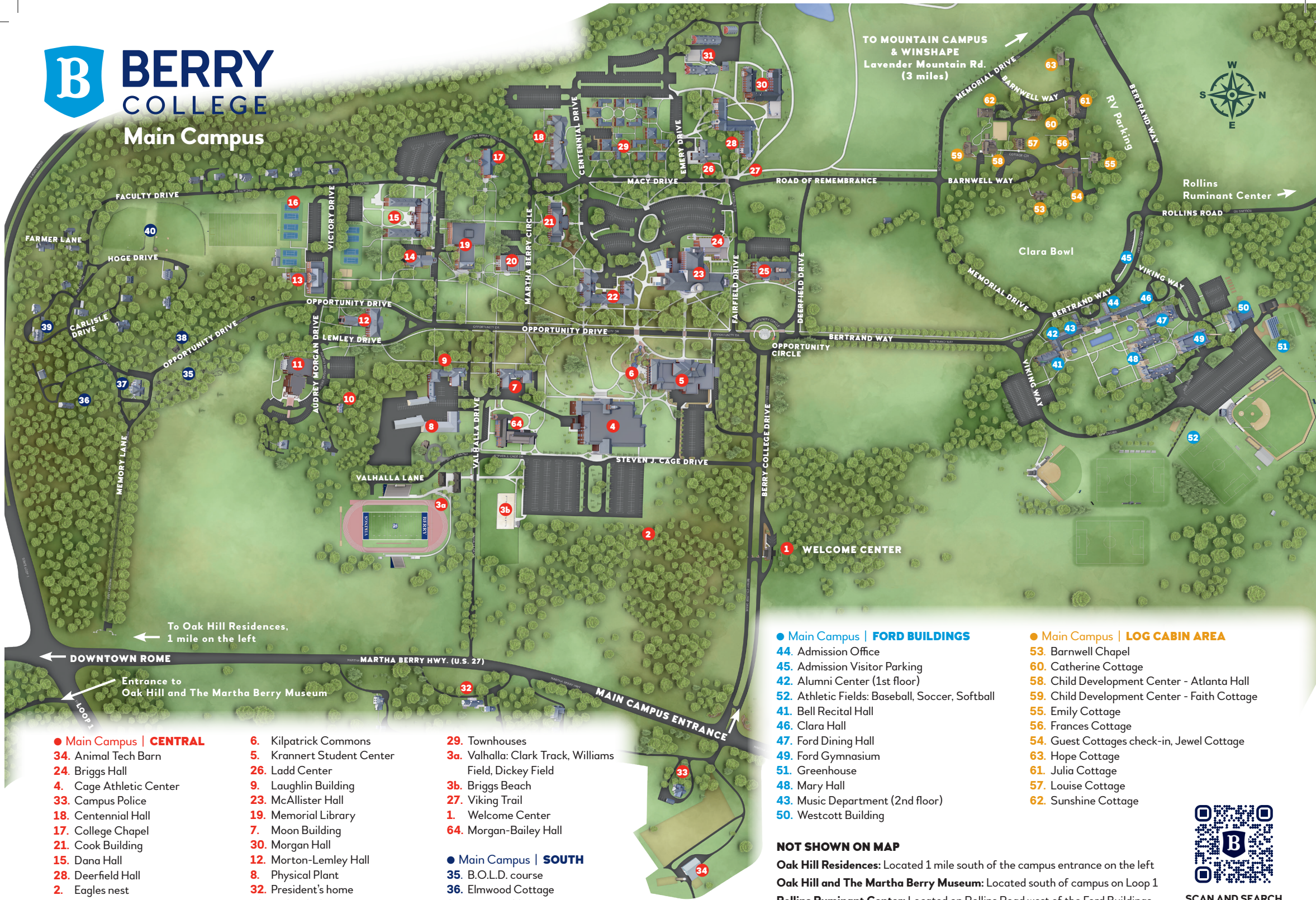

● Main Campus | CENTRAL

- 34. Animal Tech Barn
- 24. Briggs Hall
- 4. Cage Athletic Center
- 33. Campus Police
- 18. Centennial Hall
- 17. College Chapel
- 21. Cook Building
- 15. Dana Hall
- 28. Deerfield Hall
- 2. Eagles nest
- 22. Evans Hall
- 20. Green Hall
- 31. Bailey Creative Technologies/HackBerry lab
- 25. Hermann Hall

- 6. Kilpatrick Commons
- 5. Krannert Student Center
- 26. Ladd Center
- 9. Laughlin Building
- 23. McAllister Hall
- 19. Memorial Library
- 7. Moon Building
- 12. Morton-Lemley Hall
- 8. Physical Plant
- 32. President's home
- 13. Richards Gym
- 10. Robinwood Cottage
- 11. Sisters Theatre
- 16. Tennis and Pickleball Courts
- 14. Thomas Berry Hall

- 29. Townhouses
- 3a. Valhalla: Clark Track, Williams Field, Dickey Field
- 3b. Briggs Beach
- 27. Viking Trail
- 1. Welcome Center
- 64. Morgan-Bailey Hall

● Main Campus | SOUTH

- 35. B.O.L.D. course
- 36. Elmwood Cottage
- 37. Hoge Building
- 40. Intramural Sports Fields
- 39. Poland Hall
- 38. Roosevelt Cabin

● Main Campus | FORD BUILDINGS

- 44. Admission Office
- 45. Admission Visitor Parking
- 42. Alumni Center (1st floor)
- 52. Athletic Fields: Baseball, Soccer, Softball
- 41. Bell Recital Hall
- 46. Clara Hall
- 47. Ford Dining Hall
- 49. Ford Gymnasium
- 51. Greenhouse
- 48. Mary Hall
- 43. Music Department (2nd floor)
- 50. Westcott Building

● Main Campus | LOG CABIN AREA

- 53. Barnwell Chapel
- 60. Catherine Cottage
- 58. Child Development Center - Atlanta Hall
- 59. Child Development Center - Faith Cottage
- 55. Emily Cottage
- 56. Frances Cottage
- 54. Guest Cottages check-in, Jewel Cottage
- 63. Hope Cottage
- 61. Julia Cottage
- 57. Louise Cottage
- 62. Sunshine Cottage

NOT SHOWN ON MAP

Oak Hill Residences: Located 1 mile south of the campus entrance on the left

Oak Hill and The Martha Berry Museum: Located south of campus on Loop 1

Rollins Ruminant Center: Located on Rollins Road west of the Ford Buildings

Telecommunications: Located on Lavender Mountain Road (follow Memorial Drive and proceed toward Mountain Campus)



SCAN AND SEARCH
by location name
for directions.
berry.edu/campusmap

Please be respectful in and around facilities that are in use for college events or that have been reserved for private events such as weddings.

Mountain Campus & WinShape

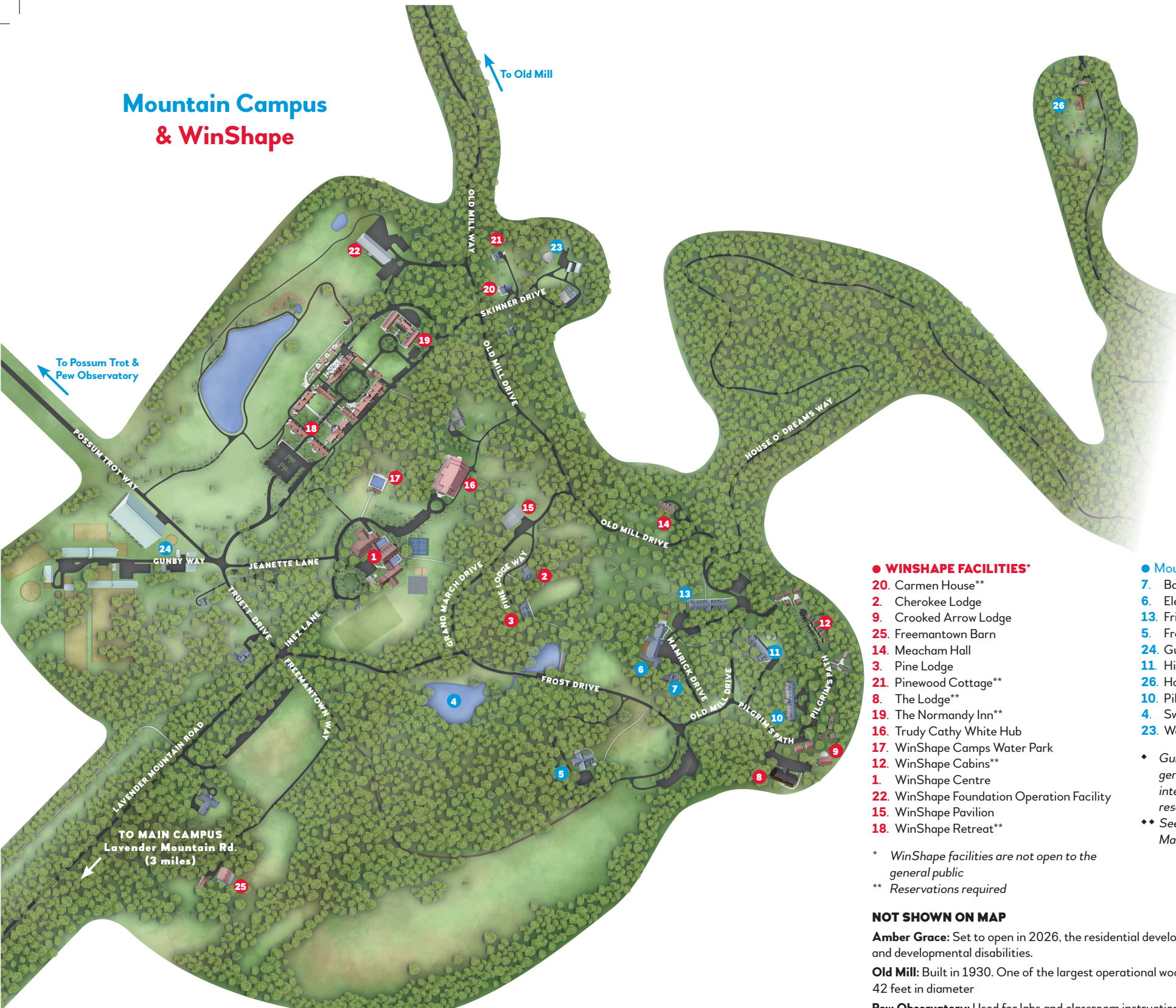

● WINSHAPE FACILITIES*

- 20. Carmen House**
- 2. Cherokee Lodge
- 9. Crooked Arrow Lodge
- 25. Freemantown Barn
- 14. Meacham Hall
- 3. Pine Lodge
- 21. Pinewood Cottage**
- 8. The Lodge**
- 19. The Normandy Inn**
- 16. Trudy Cathy White Hub
- 17. WinShape Camps Water Park
- 12. WinShape Cabins**
- 1. WinShape Centre
- 22. WinShape Foundation Operation Facility
- 15. WinShape Pavilion
- 18. WinShape Retreat**

* WinShape facilities are not open to the general public

** Reservations required

NOT SHOWN ON MAP

Amber Grace: Set to open in 2026, the residential development will serve adults with intellectual and developmental disabilities.

Old Mill: Built in 1930. One of the largest operational wooden overshot waterwheels anywhere at 42 feet in diameter

Pew Observatory: Used for labs and classroom instruction

Possum Trot: Built in 1850 and considered the "Cradle of Berry College"

● Mountain Campus | BERRY FACILITIES

- 7. Barstow Library
- 6. Elementary & Middle School, Hamrick Hall
- 13. Friendship Hall
- 5. Frost Chapel
- 24. Gunby Equine Center*
- 11. Hill Dining Hall
- 26. House o' Dreams**
- 10. Pilgrim Hall
- 4. Swan Lake
- 23. Water Filtration Plant

* Gunby Equine Center is closed to the general public except when hosting an intercollegiate competition or with a reservation. 706.236.2266

** Seen by appointment. Call Oak Hill and The Martha Berry Museum at 706.368.6777